



Boom & Balancer 933-001



Instructions:

- Secure Boom Stand (7) to work area.
- Install Height Adjustment Collar (6) onto Boom Arm (5); leave it loose at this time.
- Insert Boom Arm (5) into Boom Stand (7).
- Insert Eye Bolt (1) into Boom Arm (5) using Flat Washer (2), Lock Washer (3) and Hex Nut (4) as shown.
- Clip Tool Balancer (10) to the Eye Bolt assembly just installed.
- Attach the Hose Hammock (8) to the Tool Balancer (10) using the Quick Link (9).
- Adjust the Boom Arm to the desired height and lock in place with the Height Adjustment Collar (6).

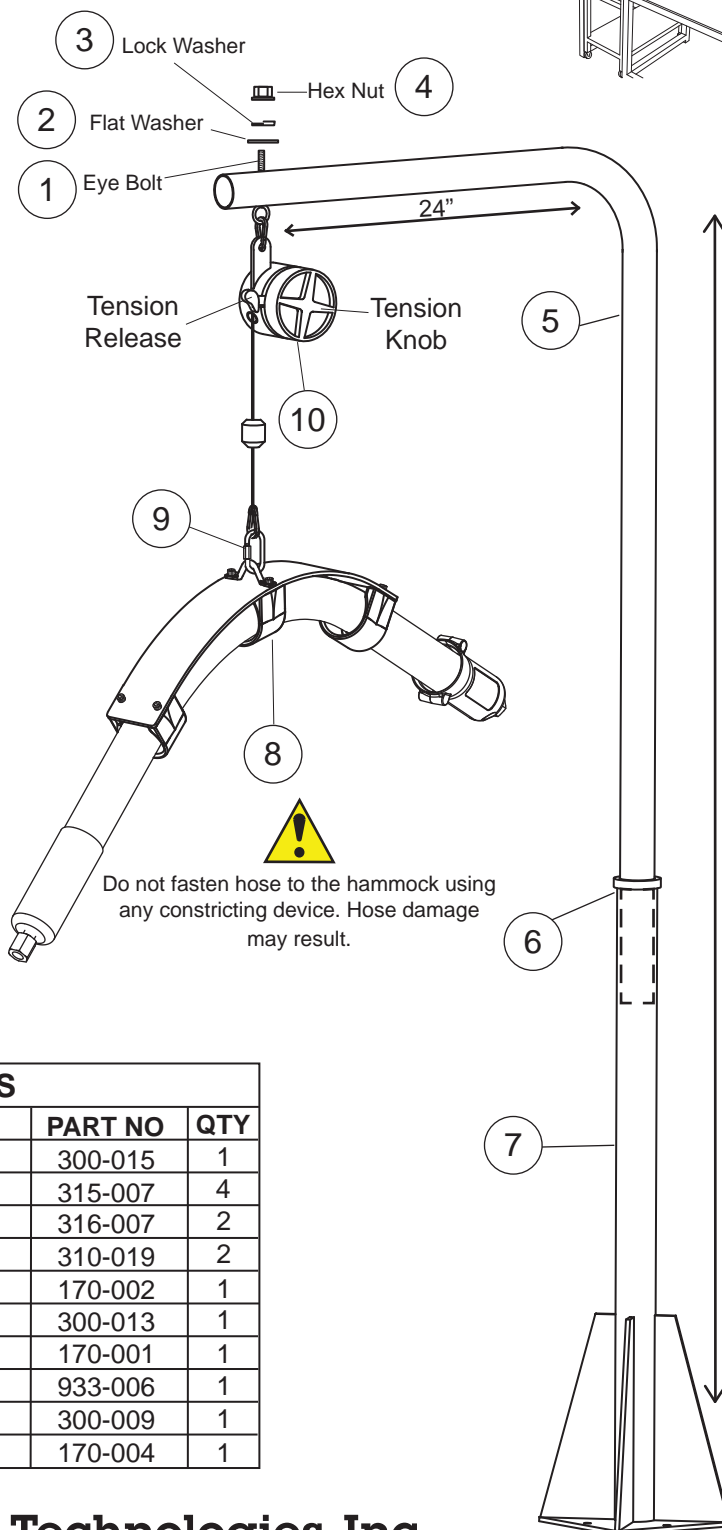
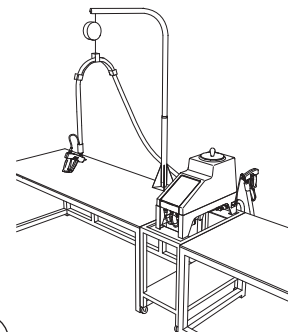

NOTE: Maximum height from bottom of Boom Stand Base is 75".

- Adjust Tension on the Tool Balancer to support Hose and Gun weight.
 - To increase tension turn the tension knob clockwise.
 - To decrease tension press the tension release button.

Overall height should not exceed 75"



Minimum engagement of Boom Arm should be no less than 6" into Boom Stand

BILL OF MATERIALS

ITEM	DESCRIPTION	PART NO	QTY
1	Eye Bolt 1/4-20 X 1"	300-015	1
2	Flat Washer 1/4"	315-007	4
3	Lock Washer 1/4"	316-007	2
4	Hex Nut 1/4-20	310-019	2
5	Boom Arm	170-002	1
6	Height Adjustment Collar	300-013	1
7	Boom Stand	170-001	1
8	Hose Hammock	933-006	1
9	Quick Link	300-009	1
10	Tool Balancer	170-004	1

Hot Melt Technologies, Inc.